

**PRODUCT: RP-SMA MALE TO SMA FEMALE ADAPTER, 50 OHM**  
**PRODUCT CODE: E3828, Paratronic Oy**

Description	Material	Note	General information	
Contact pin	Beryllium copper	1	Dimensions in millimeters (mm), unless otherwise specified. RoHS compliant. Directive 2015/863 with exemption 6(c) Note, finish, plating thickness in micro-inches, $\mu$ in (minimum): 1. Gold (3) over nickel (50) over copper (50) 2. Thin gold over nickel (50) over copper (50)	Impedance 50 ohm Frequency range DC - 18 GHz VSWR 1.20 max Insertion loss $\leq 0.3$ dB Insulator resistance $\geq 5$ G $\Omega$ Resistance, center contact $\leq 3$ m $\Omega$ , outer contact $\leq 2$ m $\Omega$ Test voltage 1000 V rms, working voltage 480 V rms Power handling $\leq 200$ W @ 2 GHz RF-leakage -60 dB min
Insulator	PTFE	-		
Body	Brass	2		
Shell	Brass	2		
Retainer rings	SUS 303	-		
Gasket	Silicone	-		

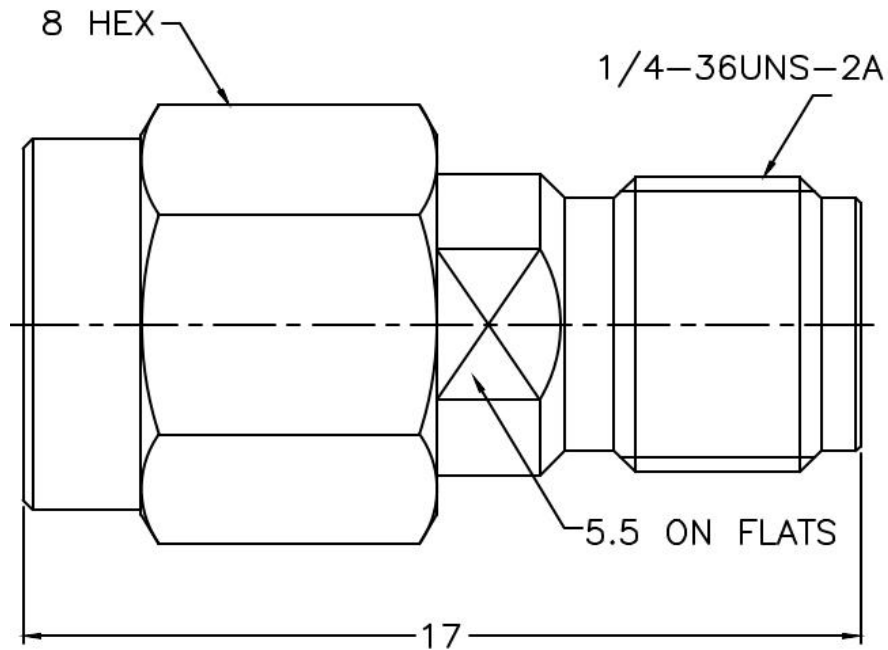

Title	Value
Drawing date	31.7.2023
Version	A
Website	www.paratronic.fi