

Installation Guide

7/16 female connector for 1/2" normal cable

ITEM : 2160305.1

Ver : 1

AFB7-8 NKC102200.12

Please read the instruction carefully before assembly. Assemble it according to this instruction exactly.

Tools : Manual cutting tool(NKA1001.12), drill tool(NKA12012.05), plier, knife, spanner, torque wrench, brush.



All dimensions in instruction are in mm.

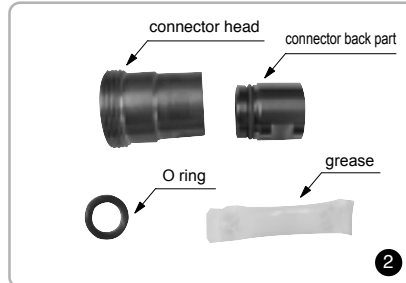

Connector Components.



CAUTION: Please wear protective glasses when install connectors.

End preparing by manual cutting tool

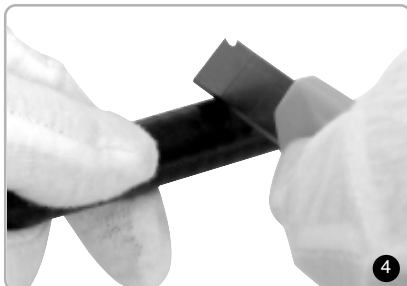

Strip off some cable jacket(20-26mm).



Place the manual cutting tool so that blade cuts second corrugation from top.

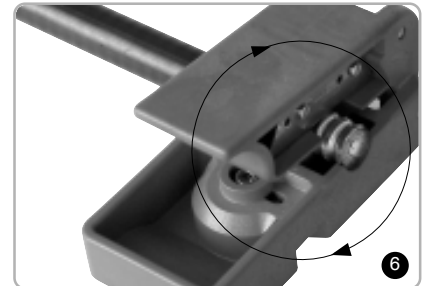

Rotate the manual cutting tool clockwise. Do not press.

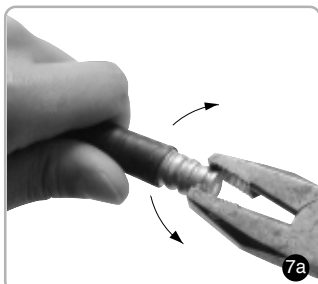

Press outer conductor and insulation by plier and turn plier clockwise and counter-clockwise until the insulation begin move along inner conductor.

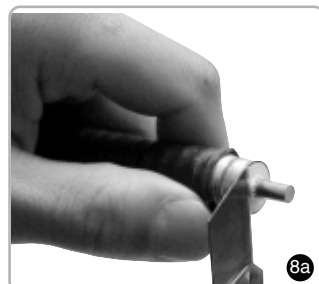

Remove all plastics from inner conductor surfaces. Do not damage inner conductor.

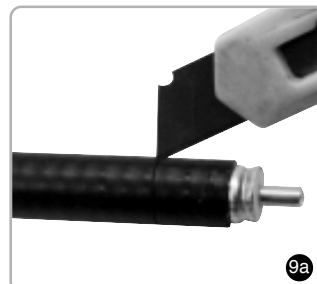

Cut jacket longitudinally by knife until radial cut which was done by manual tool blade. Remove jacket by plier.

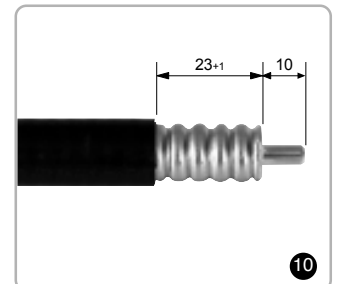

Dimension as shown. Proceed step shown in Fig.11 next.

End preparing by drill tool

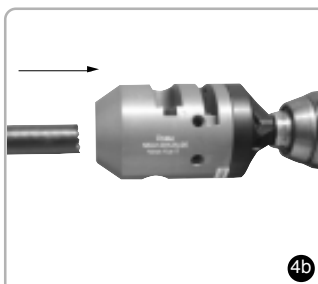

Put cable in.

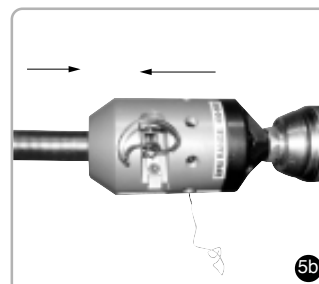

Run drill slowly and push cable to blades.

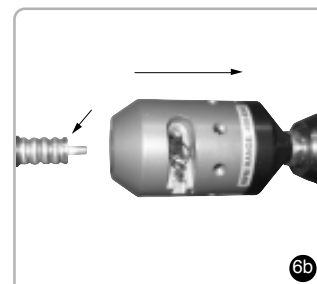

Pull drill off from cable and check the cutting position. Position is correct when outer conductor is cut top of the corrugation. Re-drill if necessary.

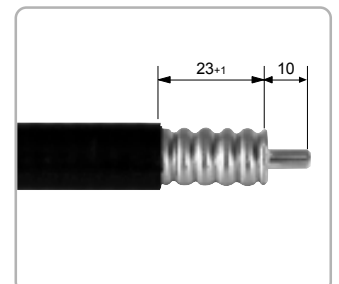

Dimension as shown. Proceed step shown in Fig.11 next.

For technical support, please contact to MNC-tech. support@draka.com

Installation Guide

7/16 female connector for 1/2" normal cable

ITEM : 2160305.1

Ver : 1

AFB7-8 NKC1012200.12

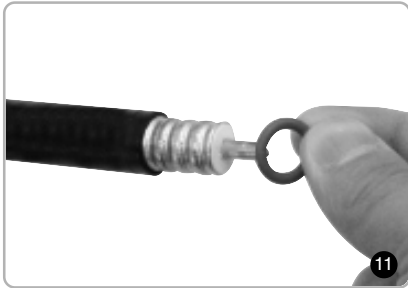

Install O-ring



Lubricate O-ring with grease.

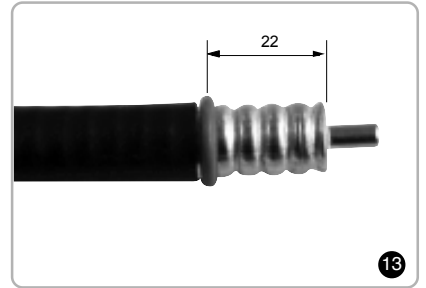

Ensure O-ring onto bottom of corrugation.

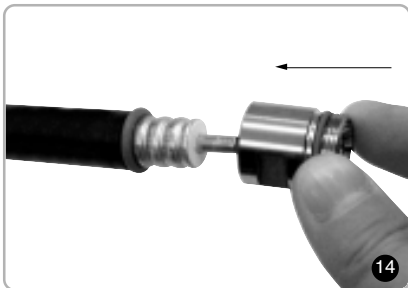

Put the connector back onto the cable by turning.

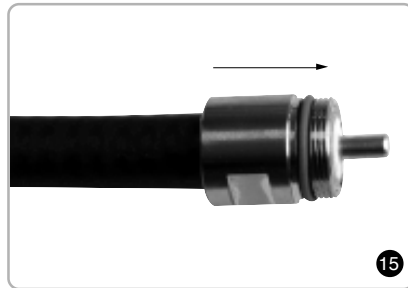

Pull the connector back part to ensure that it has locked.

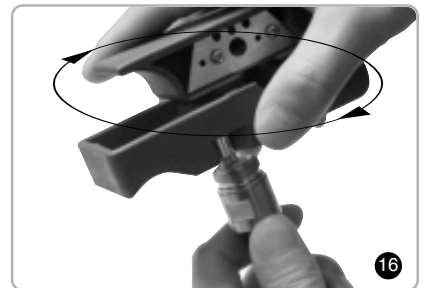

Flare the outer conductor, separate outer conductor from insulator.



Flaring as showing.



Clean all dirties carefully.



Wipe the O-ring with grease. (Well-proportioned)

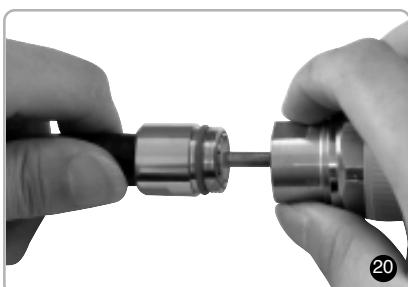

Turn connector parts together.

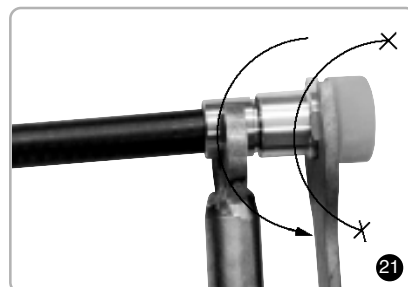

Keep the connector head steady, tighten the connector back part to torque 25 Nm.

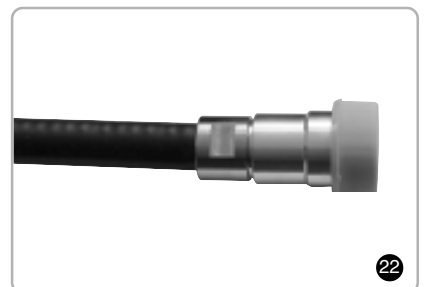

Protect interface using end cap against dirties and wet.